

### General RAD Description

The entire family of RAD models interface with HAL or Mongoose, for digital conversion at the wall. Each converts analog audio to and/or from 24-bit, 48 kHz digital audio. Shielded CAT 5e (or better) cable and termination transport four digital audio channels – two channels each direction – as well as power, ground and a communications channel, with status indicators at each RAD, HAL, EXP or Mongoose unit, and in Halogen or Tracker software. The host HAL or Mongoose auto-checks the CAT 5 crimp and verifies audio. All RADs are both “location-aware” and hot-swappable with 500-foot homerun connections (66% farther than Ethernet). Light sensors dim the RAD indicators in dark rooms. Labels can be made and printed from Halogen or Tracker software.

### RAD6

A RAD6 provides one stereo consumer line-level input on one 3.5 mm TRS and two RCA connectors, and one stereo consumer line-level output on one 3.5 mm TRS and two RCA connectors.

The RAD6 mounts in a standard 2-gang US electrical box. It is available in white, ivory, or black, with a matched Decora™ plate cover included. Order model RAD6W for white, RAD6I for ivory, and RAD6B for black.

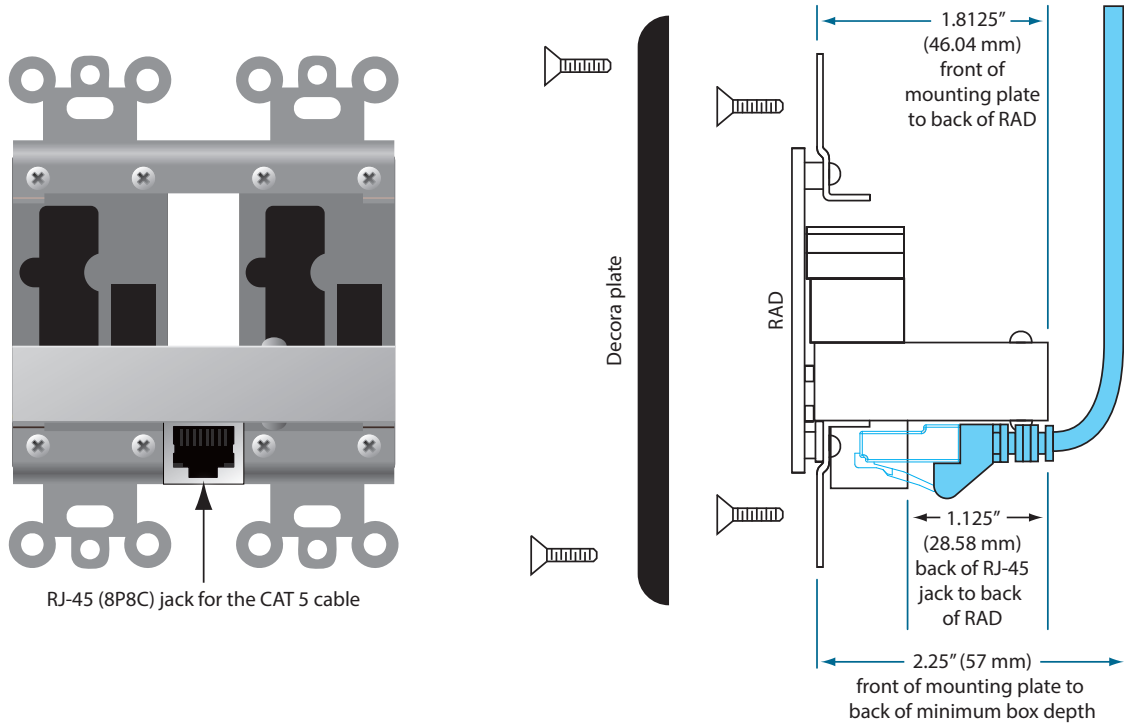



**RAD Specifications**

Parameter	Specification	Limit	Units	Conditions/Comments
Cable Length	500 feet / 153 meters			Shielded CAT 5e or better.
Signal Indicator	-50	typ.	dBFS	Unbalanced / balanced output, green LED, peak-reading
Overload Indicators	-0.5	typ.	dBFS	Unbalanced / balanced output, red LED, peak-reading
<b>Unbalanced Line-Level Input Specs</b>				
Input Impedance, Stereo	20 k	1%	$\Omega$	( <b>RAD6</b> )
Max. Input Level, Stereo	3	min.	Vrms	<1% THD ( <b>RAD6</b> )
Dynamic Range	96	typ.	dB	re: 0 dBFS, 20 kHz BW, A-weighted
Frequency Response	10 to 22k	typ.	Hz	+0, -3dB
THD+Noise	0.005	typ.	%	@ 1 kHz, 20 kHz BW, $R_s = 150 \Omega$ , Output = -6 dBFS
<b>Unbalanced Line-Level Output Specs</b>				
Output Impedance, Stereo	600	1%	$\Omega$	( <b>RAD6, RAD8, RAD11</b> )
Max. Output Level, Stereo	3.3	min.	Vrms	<1% THD, Load = 10 k $\Omega$ ( <b>RAD6, RAD8, RAD11</b> )
Dynamic Range	98	typ.	dB	Re: 0 dBFS, 20 kHz BW, A-weighted
Frequency Response	10 to 22k	typ.	Hz	+0, -3dB
<b>Unit</b>				
Conformity	CE, FCC			
...FCC	Part 15B			Class B Device
Size	4.1"H x 3.1"W x 2.1"D			10.4 x 7.9 x 5.4 cm
...Weight	4.7 oz			133 g
.....Shipping	11 oz			312 g