

General RAD Description

The entire family of RAD models interface with HAL or Mongoose, for digital conversion at the wall. Each converts analog audio to and/or from 24-bit, 48 kHz digital audio. Shielded CAT 5e (or better) cable and termination transport four digital audio channels – two channels each direction – as well as power, ground and a communications channel, with status indicators at each RAD, HAL, EXP or Mongoose unit, and in Halogen or Tracker software. The host HAL or Mongoose auto-checks the CAT 5 crimp and verifies audio. All RADs are both “location-aware” and hot-swappable with 500-foot homerun connections (66% farther than Ethernet). Light sensors dim the RAD indicators in dark rooms. Labels can be made and printed from Halogen or Tracker software.

RAD23

A RAD23 provides one balanced line inputs on an XLR connector, and one balanced line output on an XLR connector.

The RAD23 mounts in a standard 2-gang US electrical box. It is available in white, ivory, or black, with a matched Decora™ plate cover included. Order model RAD23W for white, RAD23I for ivory, and RAD23B for black.

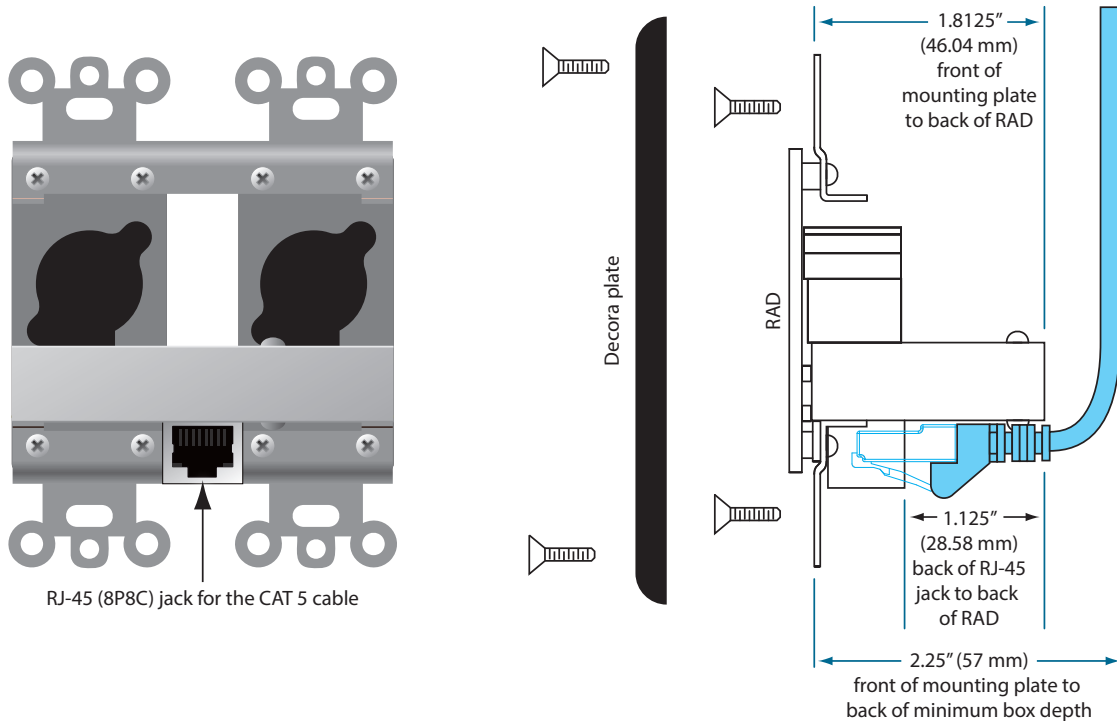



RAD Specifications

Parameter	Specification	Limit	Units	Conditions/Comments
Cable Length	500 feet / 153 meters			Shielded CAT 5e or better.
Signal Indicator	-50	typ.	dBFS	Unbalanced / balanced output, green LED, peak-reading
Overload Indicators	-0.5	typ.	dBFS	Unbalanced / balanced output, red LED, peak-reading
Balanced Line-Level Output Specs (Active Balanced)				
Output Impedance	600	1%	Ω	Each Leg
Max. Output Level	18	min.	dBu	<1% THD, Load = 10 k Ω
Dynamic Range	103	typ.	dB	re: 0 dBFS, 20 kHz BW, A-weighted
Frequency Response	10 to 22k	typ.	Hz	+0, -3dB
THD+Noise	0.017	typ.	%	@ 1 kHz, 20 kHz BW, Output = -6 dBFS
Balanced Line-Level Input Specs				
Input Impedance	22.18 k	1%	Ω	1.09 k Ω + 11.09 k Ω
Max. Input Level	23	min.	dBu	<1% THD
Dynamic Range	102	typ.	dB	re: 0 dBFS, 20 kHz BW, A-weighted
CMRR	-56	typ.	dB	Rs = 150 Ω , 1 kHz
Frequency Response	10 to 22k	typ.	Hz	+0, -3dB
THD+Noise	0.004	typ.	%	@ 1 kHz, 20 kHz BW, Rs = 150 Ω , Output = -6 dBFS
Unit				
Conformity	CE, FCC			
Size	4.1"H x 3.1"W x 2.1"D			10.4 x 7.9 x 5.4 cm
...Weight	4.7 oz			133 g
.....Shipping	11 oz			312 g